

Instructions for the SS10300 Crown & Drive Set for the LT28 Motor

This part set is used to motorize the 2" and 3" Silhouettes with an LT28 Somfy motor.

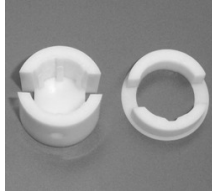

(SS10310C)
(SS10320D)
(SS10300 Set)



Somfy (RL9162132)

1. Carefully remove the clutch end of the Silhouette from the headrail.
2. Remove the clutch from the end cap and discard the clutch. Remove the idler end cap and unscrew the manual limit ring and throw it away.
3. Remove the shaft on the end cap with a hand saw or dermal tool and sand the end cap flush, marking the center of the shaft with an X.
4. Using a flush mount bracket, Somfy part #9162132, center the bracket over the X and mark the holes to be drilled in order to attach the LT28 to the end cap.
5. Drill 5/64" holes on the marks you made on the Silhouette end cap and counter sink holes.
6. Replace the pin head motor bracket with a flush mount bracket Somfy part #9162132 on the LT28 motor.
7. Attach the LT28 to the end cap with 2, 3/8" #4 counter sink screws (SC10925).
8. Slide the SS10300C crown over the LT28 motor and line up the notch on the crown to go over the tab on the limit ring.
9. Put the SS10300D drive all the way on the LT28 drive. In the provided hole attach the two drives with 1, 5/8" #4 counter sink screw (SC10800).
10. Slide the motor/end cap unit into the Silhouette tube, lining up the notches in the crown and drive together into the ridges on the inside of the tube.
11. Reassemble the shade, hang and set the limits.

Instructions for the SS10400 Crown & Drive Set for the LT28 Motor

This part set is used to motorize the 4" Silhouette with the LT28 Somfy motor.

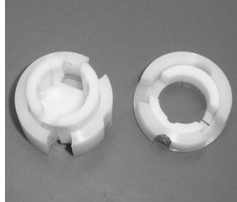

(SS10400 Set)



Somfy (RL9162132)

1. Carefully remove the clutch end of the Silhouette from the headrail.
2. Remove the clutch from the end cap and discard the clutch. Remove the idler end cap and unscrew the manual limit ring and throw it away.
3. Remove the shaft on the end cap with a hand saw or dremal tool and sand the end cap flush, marking the center of the shaft with an X.
4. Using a flush mount bracket, Somfy part #9162132, center the bracket over the X and mark the holes to be drilled in order to attach the LT28 to the end cap.
5. Drill 5/64" holes on the marks you made on the Silhouette end cap and counter sink holes.
6. Replace the pin head motor bracket with a flush mount bracket Somfy part #9162132 on the LT28 motor.
7. Attach the LT28 to the end cap with 2, 3/8" #4 counter sink screws (SC10925).
8. Slide the SS10400C crown assembly over the LT28 motor and line up the notch on the crown to go over the tab on the limit ring.
9. Put the double SS10400D drive over the LT28 drive. Remove the two small screws holding the SS10400D drives together and replace with 2, 5/8" #4 counter sink screws (SC10800) securing the SS10400D double drives and the LT28 drive together.
10. Slide the motor/end cap unit into the Silhouette tube, lining up the notches in the crown and drive to the ridges on the inside of the tube.
11. Reassemble the shade, hang and set the limits.

Instructions for the SS10500 Crown & Drive Set for the ST30 Motor

This part set is used to motorize the 4" Silhouette using the hard plastic drive on the ST30. This is the recommended system used by Reel Lift, Inc.

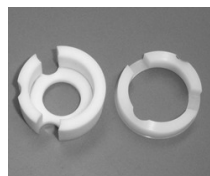

(SS10510C)
(SS10520D)
(SS10500 Set)

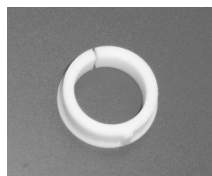

(SS10550A)

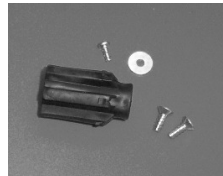

Somfy (RL9013776)



Somfy (RL9147544)

Template

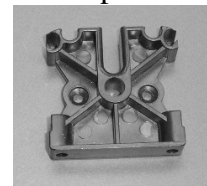

Somfy (RL9500736)

1. Carefully remove the clutch end of the Silhouette from the headrail.
2. Remove the clutch from the end cap and discard the clutch. Remove the idler end cap and unscrew the manual limit ring and throw it away.
3. Using Somfy part #9500736 as a template, drop the template over the shaft on the end cap and mark the holes for drilling. You may have to cut the top corners of this part off so it fits in the Silhouette end cap.
4. Drill 5/64" holes on the marks you made on the Silhouette end cap and counter sink holes.
5. Set the motor assembly up by first sliding the SS10550A adapter on to the motor and then sliding the SS10500C crown over the SS10550A adapter, lining up the tab on the first part with the notch on the second part. These do not need to be attached.
6. Slide the #9013776 Somfy drive adapter onto the drive end of the motor, secure adapter with **one 1/2" #4, pan head screw (SC10860) and washer**. Don't use the screw in the Somfy kit, it is too short, hand tighten. The small end of the adapter should point away from the motor head.
7. Snap on the #9147544 hard plastic drive over the #9013776 adapter.
8. Slide the SS10500D drive over the hard plastic drive and attach the two drives together using the holes provided with **2, 5/8" #4 counter sink screws (SC10800)**.
9. Take the motor assembly and push it on to the shaft of the end cap, line up the holes and attach them together with the **2, 3/8" #4, flat end countersink screws (SC10900)**.
10. Slide the motor/end cap unit into the Silhouette tube, lining up the notches in the crown and drive to the ridges on the inside of the tube.
11. Reassemble the shade, hang and set the limits.

Instructions for the SS10500 Crown & Drive Set for 40mm Motors

This part set is used to motorize the 4" Silhouette using the Somfy 9012224 Crown & Drive Set for the 40mm motors.

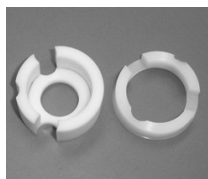

(SS10510C)
(SS10520D)
(SS10500 Set)



Somfy (RL9012224 Set)

Template

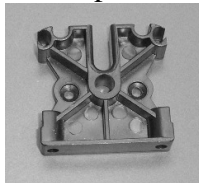

Somfy (RL9500736)

1. Carefully remove the clutch end of the Silhouette from the headrail.
2. Unscrew the clutch from the end cap and discard the clutch. Remove the idler end cap and unscrew the manual limit ring and throw it away.
3. Using a Somfy part #9500736 as a template, drop the template over the shaft on the end cap and mark the holes for drilling. You may have to cut the top corners of this part off so it fits in the Silhouette end cap.
4. Drill 5/64" holes on the marks you made on the Silhouette end cap and counter sink holes.
5. Set the motor assembly up by first sliding the #9012224 crown on to the motor. Set the notch over the tab on the motor. Then sliding the SS10500C crown over the #9012224 crown line up the notch on the SS10500C crown with the tab on the #9012224 crown.
6. Snap on the #9012224 hard plastic drive over the shaft on the drive end of the motor.
7. Slide the SS10500D drive over the #9012224 drive and attach the two drives using the holes provided with 2, 5/8" #4 counter sink screws (SC10800).
8. Take the motor assembly and push it on to the shaft of the end cap, line up the holes and attach them together with the 2, 3/8" #4 flat end countersink screws (SC10900).
9. Slide the motor/end cap unit into the Silhouette tube, lining up the notches in the crown and drive to the ridges on the inside of the tube.
10. Reassemble the shade, hang and set the limits.

Instructions for the SS10600 Crown & Drive Set for the ST30 Motor

This part set is used to motorize the 4" Silhouette using the Somfy #9013775 soft rubber adapter on the ST30. This method is preferred by some of our customers.



1. Carefully remove the clutch end of the Silhouette from the headrail.
2. Remove the clutch from the end cap and discard the clutch. Remove the idler end cap and unscrew the manual limit ring and throw it away.
3. Using a Somfy part #9500736 as a template, drop the template over the shaft and mark the holes for drilling. You may have to cut the top corners of this part off so it fits in the Silhouette end cap.
4. Drill 5/64" holes on the marks you made on the Silhouette end cap and counter sink holes.
5. Set the motor assembly up by first sliding the #9013775 crown on to the motor and then sliding the SS10600C crown over the #9013775 crown. These do not need to be attached.
6. Attach the #9013775 Somfy rubber drive on to the end of the motor and secure with the washer and one 1/2", #4 pan head screw (SC10860). Don't use the screw in the Somfy kit, it is too short, hand tighten.
7. Slide the SS10600D drive over the rubber drive and attach the two drives using the holes provided in the SS10600D drive with 2, 5/8" #4 counter sink screw (SC10800). Push ST30 motor head onto the Silhouette end cap, line up the wholes on the ST30 motor head and the wholes you drilled in the Silhouette end cap and attach them together with 2, 3/8" #4 flat countersink screws (SC10900).
8. Slide the motor/end cap unit into the Silhouette tube lining up the notches in the crown and drive to the ridges on the inside of the tube.
9. Reassemble the shade, hang and set the limits.

Instructions for the SS10600 Crown & Drive Set for the LT30 Motor

This part set is used to motorize the 4" Silhouette using LT30 and requiring the Somfy #9013488 Crown and Drive for the 1 1/2" Rollease tube.



1. Carefully remove the clutch end of the Silhouette from the headrail.
2. Remove the clutch from the end cap and discard the clutch. Remove the idler end cap and unscrew the manual limit ring and throw it away.
3. Using a Somfy part #9500736 as a template, drop the template over the shaft and mark the holes for drilling. You may have to cut the top corners of this part off so it fits in the Silhouette end cap.
4. Drill 5/64" holes and counter sink. Drill 5/64" holes on the marks you made on the Silhouette end cap and counter sink holes.
5. Set the motor assembly up by first cutting off the small shave bars on the #9013488 crown. They are about 3/4" long and are located at the top of the crown in between the long thick legs that hold the magnets.
6. Look down the legs on the #9013488 crown and mark the largest leg without a magnet. Slide the #9013488 crown on to the motor and then slide the SS10600C crown over the #9013488 crown. Drill a 5/64" hole (and countersink) through the SS10600C crown and into the leg with the mark. Screw both crowns together with 1, #4, 3/8" countersink screw (SC10925).
7. Attach the #9013488 Somfy rubber drive to the end of the motor and secure with 1, 1/2", #4 pan head screw (SC10860). Don't use the screw in the Somfy kit, it is too short, hand tighten.
8. Slide the SS10600D drive over the rubber drive and attach the two drives using the holes provided with 2, 5/8" #4 counter sink screws SC10800.
9. Remove plastic cover on the end of the LT30. You will see two screw holes. Push the motor on to the shaft on the end cap and line the holes you drilled in the end cap up with the holes on the motor and attach them together with the 2, 3/8" #6 flat countersink screws (SC10900).
10. Slide the motor/end cap unit into the Silhouette tube, lining up the notches in the crown and drive to the ridges on the inside of the tube.
11. Reassemble the shade, hang and set the limits.

Instructions for Changing Tube on the 2" & 3" Silhouette to use the ST30 Motor

Template

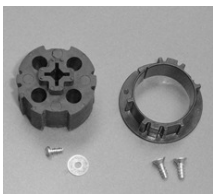

Somfy (RL9500736)

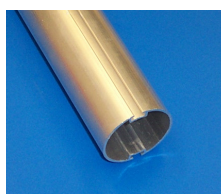

(AC10050)

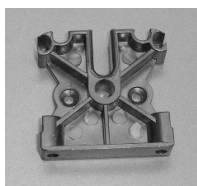

(RL9500736)

1. Carefully remove the clutch end of the Silhouette from the headrail.
2. Remove the clutch from the end cap and discard the clutch. Remove the idler end cap and unscrew the manual limit ring and throw it away.
3. With the shade out of the headrail, roll the Silhouette all the way up on the bottom bar and lay the shade flat on the table. Carefully slide the shade off the tube that it is on, making note of how the stiffeners on the shade are angled in the front and back slots of the tube.
4. Cut a piece of the (AC10050) tube the exact length of the tube you are removing. On one end of the new tube use a small file and round off all four corners of the slot openings. Work until the corners are blunt and very smooth. Position the blunt end of the tube at one end of the shade and angle both front and back stiffeners on the shade in the new tube. CAREFULLY, inch by inch ease the shade on to the new tube, being very careful not to snag the fabric and rip a hole in it. Watch both sides.
5. Using Somfy part #9500736 as a template, drop the template over the shaft and mark the holes for drilling. You may have to cut the top corners of this part off so it fits in the Silhouette end cap.
6. Drill 5/64" holes on the marks you made on the Silhouette end cap and counter sink holes.
7. Put the Somfy 9013775 crown and drive on the ST30 motor. Attach the #9013775 Somfy rubber drive to the end of the motor and secure with the washer and 1, 1/2", #4 pan head screw (SC10860). Don't use the screw in the Somfy kit, it is too short, hand tighten.
8. Push Silhouette end cap onto the ST30 motor head. Line up the wholes on the ST30 motor head and the wholes you drilled in the Silhouette end cap and attach them together with 2, 3/8" #4 flat countersink screws (SC10900).
9. Slide the motor assembly in to the new tube, lining up the small cavities in the crown and drive to the slots inside the tube.
10. Take the original idler end from the Silhouette and wrap a couple of layers of duct tape (not masking tape) around it until it is a tight fit when inserted in the end of the tube.
11. Reassemble the shade, hang and set the limits.

Check Lists for Crown and Drive Applications

Each list is for one shade

SS10300

RL9162132
SC10925
SC10800

Crown and Drive Set for LT28 Motors

Flush Mount Bracket for LT28 Motor
2 – 3/8" #4 screws
1 – 5/8" #4 screw

SS10400

RL9162132
SC10925
SC10800

Crown and Drive Set for LT28 Motor for 4" Silhouette

Flush Mount Bracket for LT28 Motor
2 – 3/8" #4 screws
1 – 5/8" #4 screw

SS10500

SS10550A
RL9013776
RL9147544
SC10860
SC10800
SC10900
RL9500736

Crown and Drive Set for Sonesse 30 Motor for 4" Silhouette (hard drive)

Crown that replaces crown in Somfy 9013776 to fit 40mm tube
Somfy ST30 Adapter kit for 40mm tube
Hard plastic Drive
1 - 1/2" #4 screw replaces small screw in Somfy 9013776
2 – 5/8" #4 screws
2 – 3/8" #4 flat end screws for Sonesse 30 Motor
Part used as a template for marking holes to be drilled on Silhouette end caps

SS10500

RL9012224
SC10800
SC10900
RL9500736

Crown and Drive Set for 40mm Motor for 4" Silhouette

Crown and Drive Set for 40mm Motor
2 – 5/8" #4 screws
2 – 3/8" #4 flat end screws for Sonesse 30 Motor
Part used as a template for marking holes to be drilled on Silhouette end caps

SS10600

RL9013775
SC10860
SC10800
SC10900
RL9500736

Crown and Drive Set for Sonesse 30 Motor for 4" Silhouette (rubber drive)

Somfy ST30 Adapter kit for 1 1/2" tube
1 - 1/2" #4 screw replaces small screw in Somfy 9013776
2 – 5/8" #4 screws
2 – 3/8" #4 flat end screws for Sonesse 30 Motor
Part used as a template for marking holes to be drilled on Silhouette end caps

SS10600

RL9013488
SC10925
SC10860
SC10800
SC10900
RL9500736

Crown and Drive Set for LT30 for 4" Silhouette**

LT30 Crown and Drive Pack for the 1 1/2" Tube
1 – 3/8" #4 screw
1 - 1/2" #4 screw replaces small screw in Somfy 9013776
2 – 5/8" #4 screws
2 – 3/8" #4 flat end screws for Sonesse 30 Motor
Part used as a template for marking holes to be drilled on Silhouette end caps

** Check Price List for Power Options for the LT30

List of Parts Needed to use Sonesse 30 in a 2" or 3" Silhouette

This requires replacing the manufacturer's tube with a new tube suitable for the Sonesse 30

RL9013775	ST30 Crown and Drive Adapter Kit for 1 1/2" tube
AC10500	Tube to replace manufacturer's tube (order by the foot)
SC10860	1 - 1/2" #4 screw replaces small screw in Somfy 9013776
SC10900	2 - 3/8" #4 flat end screws for Sonesse 30 Motor
RL9500736	Part used as a template for marking holes to be drilled on Silhouette end caps